



www.insize.com



OPERATION MANUAL

**Model ISF-LR
Manual Test Stand**



Functions and Characters

ISF-LR Manual Test Stand is especially designed to match ISF-F, ISF-DF series and can be combined into a wide use of stands, apply in various testing purposes, such as switch test, connector insertion / withdraw test, and fracture test. The motive carrier is designed with the test stand and can be moved on X&Y axis. The design is convenient to fix clamps.

- Dimension: LxWxH(cm) 25x36x47
- Capacity: 500N; Stroke: 170mm
- Applied with: ISF-F/ISF-DF series of Push Pull Gauge; Digital scales and various clamps.

The installation of the test stand

- (1) It can be put on various working tables to use. You can get correct testing value by using 4 adjusted screws to keep the test stand in balance. You also can fix the test stand on the working table to make it more steady. You can install the test stand as your mind when testing. Please refer to the dimension on right picture to install.

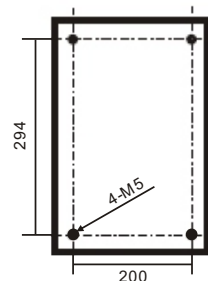

Vertical Installation

- (2) Installment of force gauge
 - A. Loosen the screws on the movable board and take the board off.
 - B. Installment of analogue Push Pull Gauge: Take off 4 units of M3x8 bolt in the behind of the gauge, change into 4 units M3x14 bolts. Then install the push pull gauge onto the test stand.
 - C. Installment of digital Push Pull Gauge: Install push pull gauge onto the test stand by using 4 units of M3x8 bolts.

Measurement:

According to the characteristic of testing sample, putting or installing it in a suitable position of working table. Circumvolving the handwheel of the test stand, the test stand can move up-down steadily to complete the test.

Maintains

- (1) Please don't use it exceeding max load. The rated load of this test stand is 500N.
- (2) Pay attention to daily maintenance, and keep its all components clean.
- (3) If there is something nonskid when use it, please pour a litter Lubricant. When there is something wrong with the test stand, please contact the manufacturer or original saler. (Please don't disassemble or repair it by yourself, if not allowed.)

Optional ISF-F Series Analog Push Pull Gauge Specification Parameter:

Model	ISF-F10	ISF-F20	ISF-F30	ISF-F50	ISF-F100	ISF-F200	ISF-F300	ISF-F500
Capacity	10N	20N	30N	50N	100N	200N	300N	500N
Resolution	0.05N	0.1N	0.2N	0.2N	0.5N	1N	2N	2N
Accuracy	± 1%							

Optional ISF-DF Series Analog Push Pull Gauge Specification Parameter:

Model	ISF-DF2	ISF-DF5	ISF-DF10	ISF-DF20	ISF-DF50	ISF-DF100	ISF-DF200	ISF-DF500
Capacity	2N	5N	10N	20N	50N	100N	200N	500N
Resolution	0.001N	0.001N	0.005N	0.01N	0.01N	0.05N	0.1N	0.1N
Accuracy	± 0.5%							

Package List

Name	Quantity
ISF-LR main body	1pc
M6 Inner-hexad spanner	1pc
M6 X 25 Double-head screw, M6 Nut	1pc
Manual	1pc
Qualification Certificate	1pc